

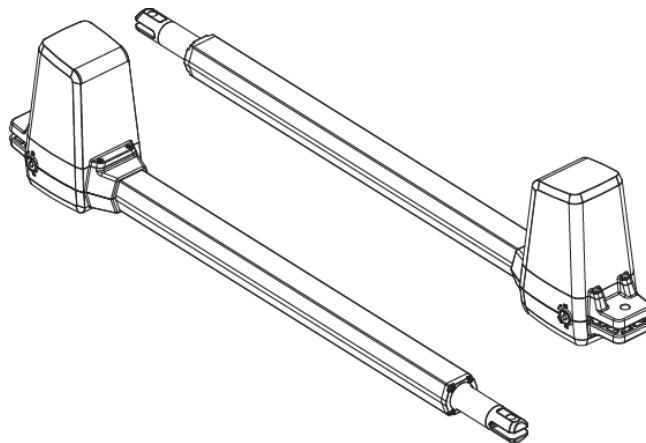

# iS260 / iS260D

## SWING GATE OPENER

### USER MANUAL



Scan the QR code for more details



Reuse  
Reduce  
Recycle



# INDEX

1.1	GENERAL SAFETY PRECAUTION .....	P.1
1.2	INSTALLATION	
	A. STANDARD INSTALLATION .....	P.2
	B. INSTALLATION CHECK .....	P.3
	C. REAR BRACKET INSTALLATION .....	P.4
	D. FRONT BRACKET INSTALLATION .....	P.5
	E. WIRE CONNECTION .....	P.6
	F. EMERGENCY RELEASE .....	P.7
1.3	TECHNICAL FEATURES	
	A. TECHNICAL FEATURES .....	P.8
	B. DIMENSION .....	P.8
1.4	MAINTENANCE .....	P.9

## 1.1 GENERAL PRECAUTION

### **WARNING:**

**This user manual is only for qualified technicians who are specialized in installations and automations.**

- 1) All installations, electrical connections, adjustments and testing must be performed only after reading and understanding of all instructions carefully.
- 2) Before carrying out any installation or maintenance operation, disconnect the electrical power supply by turning off the mains switch connected upstream and apply the hazard area notice required by applicable regulations.
- 3) Make sure the existing structure is up to standard in terms of strength and stability.
- 4) When necessary, connect the motorized gate to reliable earth system during electricity connection phase.
- 5) Installation requires qualified personnel with mechanical and electrical skills.
- 6) Keep the automatic controls (remote, push buttons, key selectors. Etc) placed properly and way from children.
- 7) For replace or repair of motorized system, only original parts must be used. Any damage caused by inadequate parts and methods will be not claimed to motor manufacturer.
- 8) Never operate the drive if you suspect that it might be faulty or will cause damage to the system.
- 9) The motors are exclusively designed for gate opening and closing application, any other usage is deemed inappropriate. The manufacturer will not be liable for any damage resulting from the improper use. Improper usage should void all warranty, and the user accepts sole responsibility for any risks thereby may accrue.
- 10) The system may be operated in proper working order. Always follow the standard procedures by following the instructions in this installation and operating manual.
- 11) Only operate the remote when you have the full view of the gate.

**ELSEMA PTY LTD shall not be liable for any injury, damage, or any claim to any person or property which may result from improper use or installation of this system.**

Please keep this installation manual for future reference.

## 1.2 STANDARD INSTALLATION

### A. STANDARD INSTALLATION

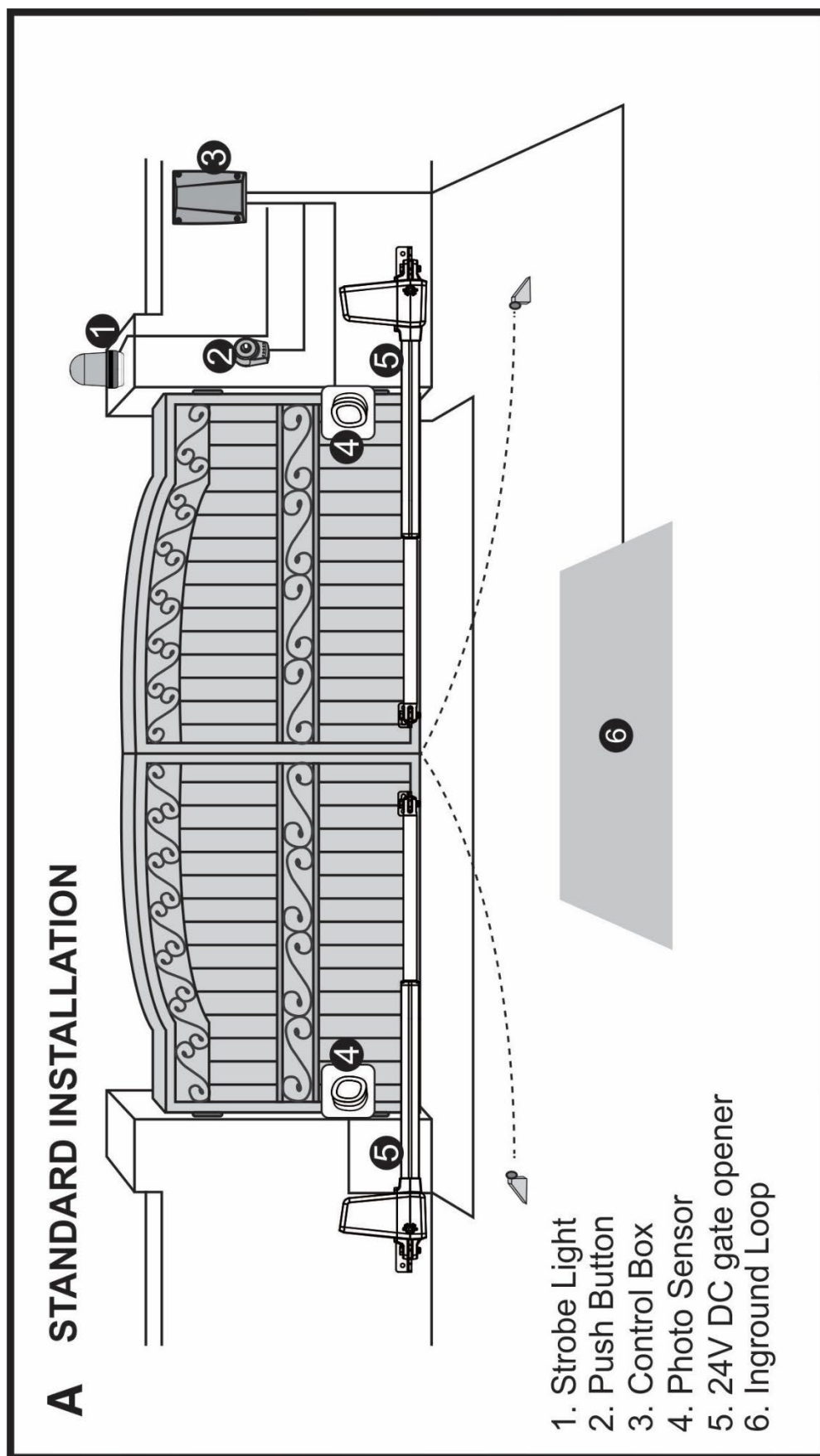

## B. CHECKS BEFORE INSTALLATION

Before proceeding with the installation check the following:

- 1) Be sure that gate moves freely
- 2) There are no obstacles in the moving gate area
- 3) Hinges are properly positioned and greased
- 4) There should be no friction between the gate leaf's
- 5) There should be no friction with the ground while moving the gates
- 6) Check that the gate structure is suitable to install automatic gate motors
- 7) "C" value is 140mm
- 8) "D" can be measured from the gate easily
- 9) "A" = "C" + "D"
- 10) The value of "B" can be calculated from the value of "A" and the leaves opening angle

**\*\*Please make sure "B" and "A" are similar or the same in value that the leaf's can be operated smoothly, also to reduce the burden of the motor.**

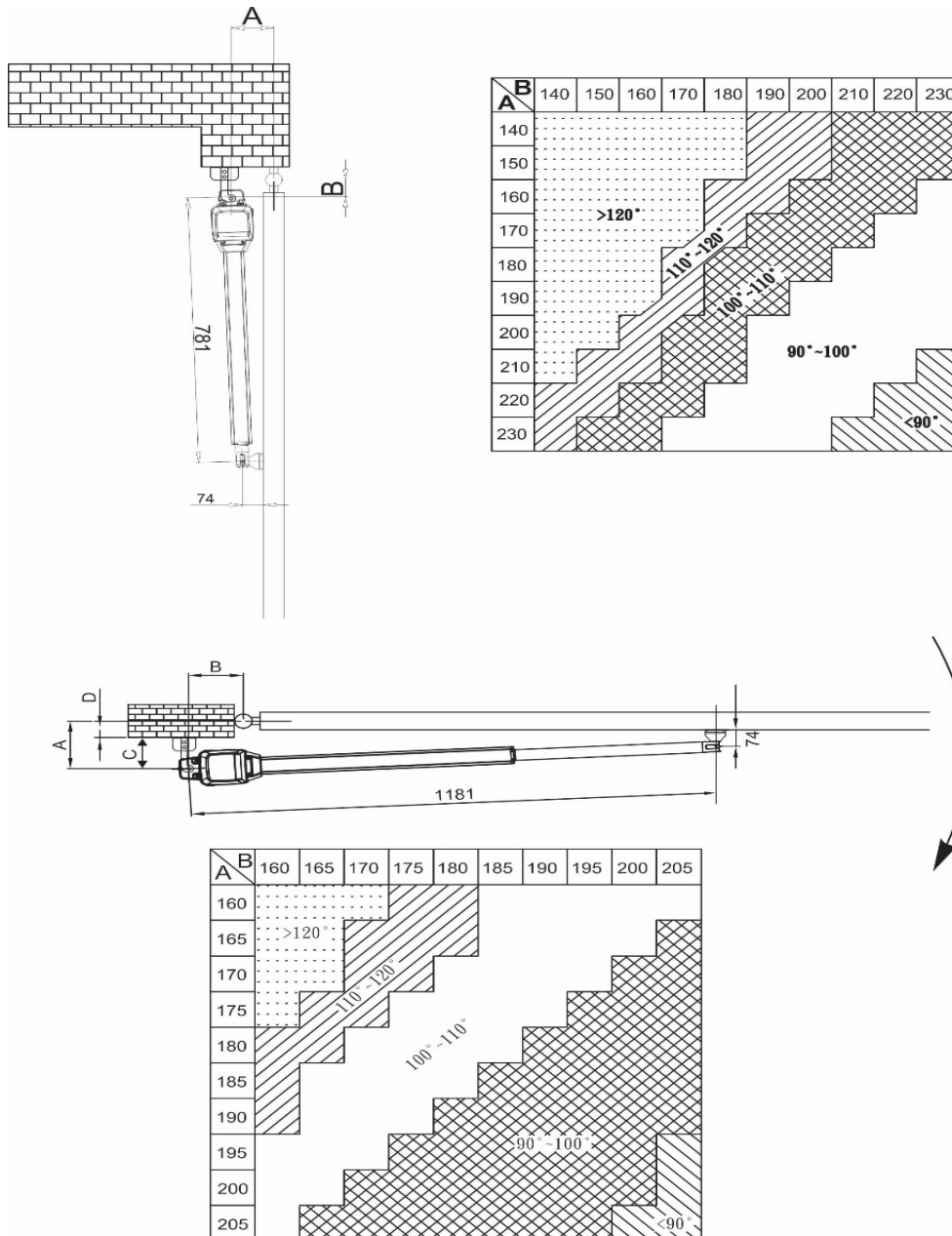

## C. INSTALLATION OF REAR BRACKET

**Step 1:** Before securing the rear bracket to the pillar check the front bracket to make sure can be welded to a solid point on the gate leaf.

- Fully close the gate. Fully extend the motor shaft. This will be the gate's fully closed position
- Connect the rear and front brackets to the motor
- Hold the rear bracket onto the pillar with the calculated **A** and **B** values.
- Move the motor in a vertical direction until the fixing zone is in a solid area of the gate leaf for the front bracket.
- Make sure the physical stoppers are strong enough to stop the gate in open and closed positions.
- Open position of the gate can be adjustable by the shaft clamp.

**Step 2:** Then fix the rear bracket to the pillar.

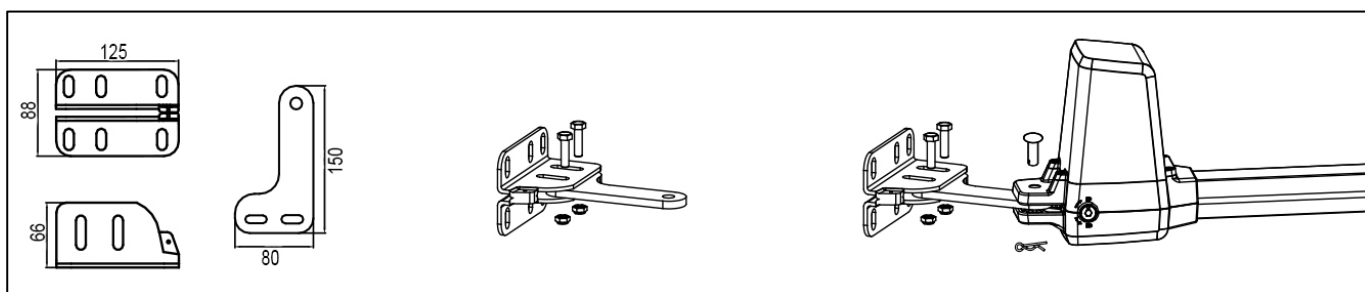

**Step 3:** Fix the operator on the rear bracket.

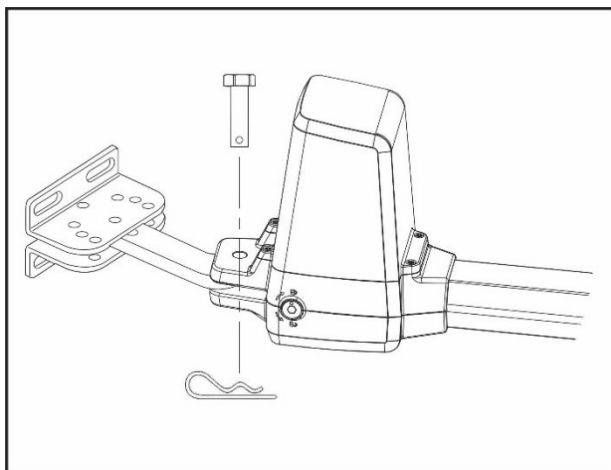

## D. INSTALLATION OF FRONT BRACKET

Disengage the motor and attached the front bracket to the motor as shown below.

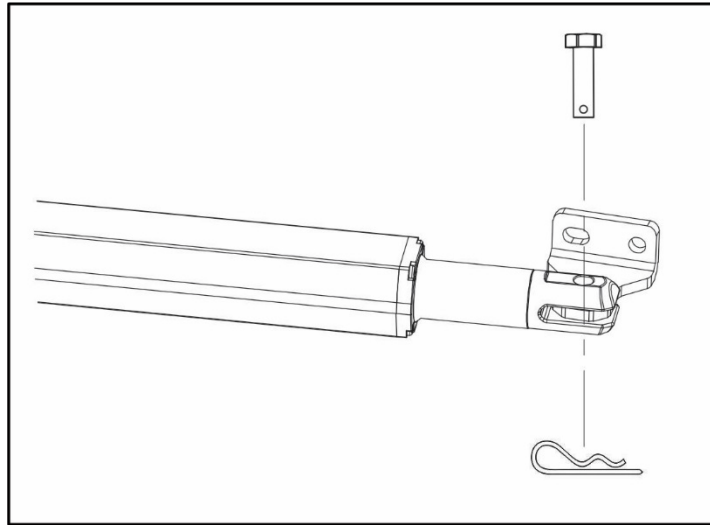

Position the front bracket in its position and manually move to gate to see that the motor is in the horizontal position in these positions:

- 1) Gate in "CLOSE" position
- 2) Gate in "OPEN" position
- 3) Gate at "45° angle" position

Prior to welding the bracket on the gate leaf (if necessary), cover the gate opener to prevent damages from sparks.

A fixed in-ground stopper should be placed to stop the gate in the fully closed position. The fully open position is determined by either physical stoppers or the clamps included in the kit which can be clamped on the motor shaft and adjusted to the desired position.

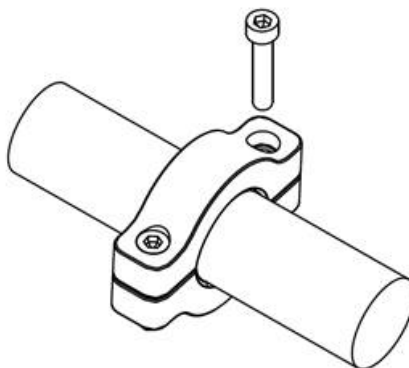

## E. WIRE CONNECTION

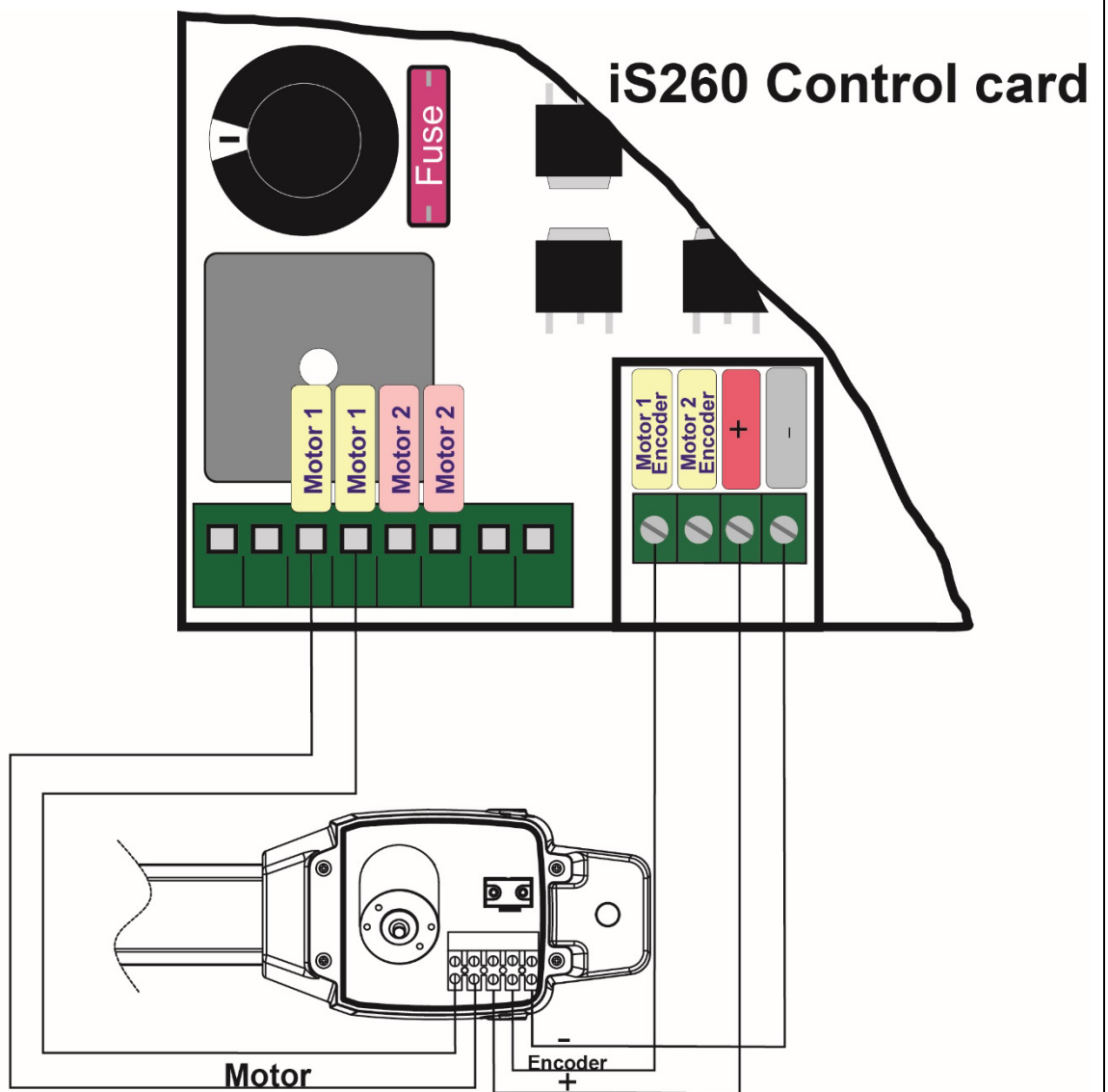

**Wire 2nd motor to the "Motor 2" and the motor 2 encoder wire to "Motor 2 Encoder" terminal**



## G. EMERGENCY RELEASE

In case of power failure, the operator can be disengaged to move the gate. A release key is provided with the kit.

- 1) Insert the release key to the manual release slot on either side of the motor
- 2) Turn the release key in the direction shown on the motor to the unlock position
- 3) Pull the release key out before moving the gate manually
- 4) The turning direction will be reversed for right motor

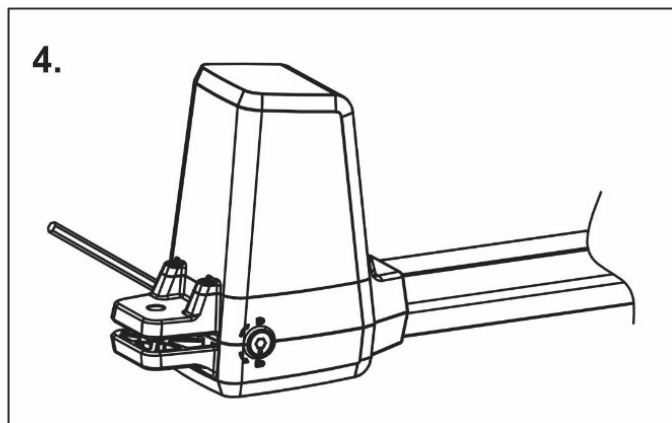
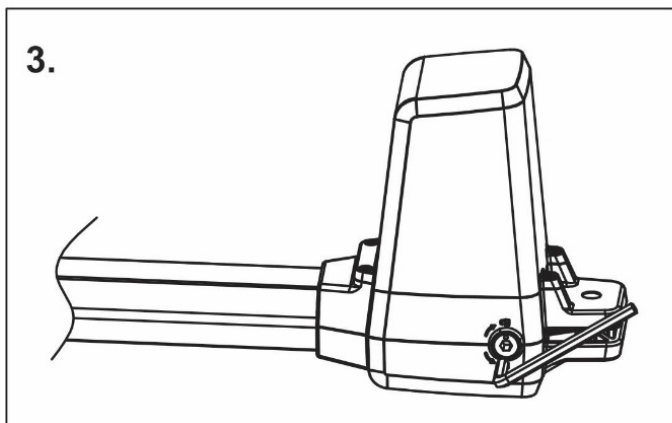
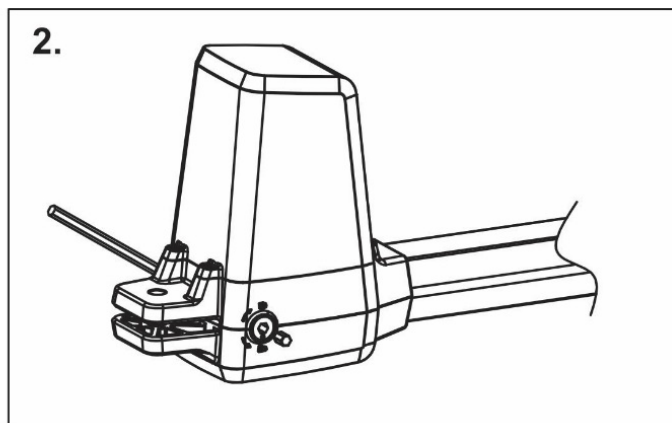
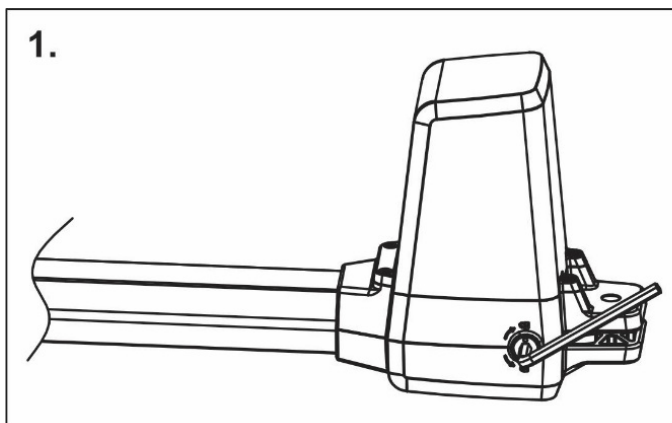

## I. ELECTRICAL CONNECTION

After successful motor installation, refer to the user manual of the control card for automatic operation setup. Scan the below QR code for control card instructions.



## 1.3 TECHNICAL FEATURES:

Motor Voltage	24 Volts DC motor
Gear Type	Worm gear
Nominal Thrust	2000N
Stroke Length (CD)	400mm
Power Supply	240 Volts AC
Nominal Input Current	2 Amps
Maximum Operating Current	4.2 Amps for maximum 10 sec
Maximum Gate Weight	200 kg per leaf
Maximum Gate Length	2.5 metres
Duty Cycle	20%
Operating Temperature	-20°C ~ +50°C
Dimension	819mm x 197mm x 100mm

### B Dimension:

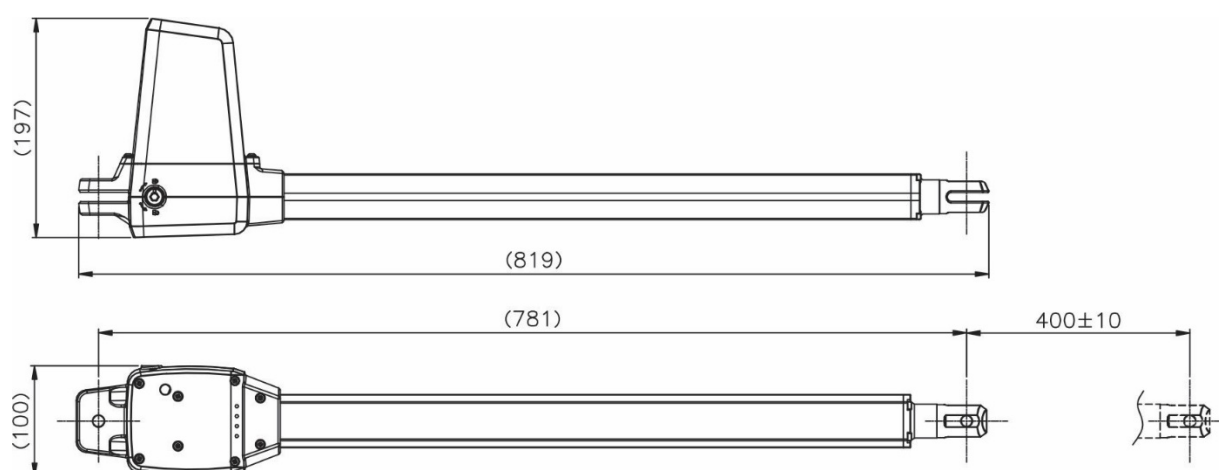

## 1.4 MAINTENANCE:

Maintenance should be performed at least every six months. If it is used in high traffic area, a more regular maintenance should be performed.

### Disconnect the power supply:

- (1) Clean and lubricate the screws, the pins and the hinge with grease.
- (2) Check the fastening points are properly tightened.
- (3) Check and make sure that the wire connections are in good condition.

### Connect the power supply:

- (1) Check the power adjustments.
- (2) Check the function of the manual release
- (3) Check the photocells or other safety device.

## Service History

Date	Maintenance	Installer

- **Solar kits**
- **Solar panels**
- **Backup batteries**
- **Photo electric beams**
- **Magnetic locks**
- **Wireless keypads**
- **Pre formed vehicle loop**

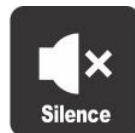

Visit [www.elsema.com](http://www.elsema.com) to see our full range  
of Gate and Door Automation products